

**SOURCE SOILS EXCAVATION PLAN (CP-38)**

**Rice Oil Company, Inc.  
c/o Mr. Rick Parrott  
Harpersville Coosa Mart  
ADEM Facility ID: 15217-117-007086  
UST Incident Number: UST12-03-10  
237 Highway 280 East  
Harpersville, Alabama 35078  
(Shelby County)**

**March 20, 2024**

**Prepared for:  
Rice Oil Company, Inc.  
c/o Mr. Rick Parrott  
404 Sterling Park Circle  
Alabaster, Alabama 35007**

**Prepared by:  
**SPHERE 3** ENGINEERING, INC  
(Alabama General Contractor #49971)  
3433 Sierra Drive  
Hoover, Alabama 35216  
Phone: (205) 403-3317**

**SPHERE 3 File: RP-ROC.HCM.38**



CERTIFICATION PAGE

*I certify under penalty of law that this Source Soils Excavation Plan and all specifications, and technical data submitted within were prepared under my direction or supervision in accordance with a system designed to assure that qualified personnel properly gathered and evaluated the information submitted. Based on my inquiring of the person or persons who directly gathered the enclosed information, the information submitted is to the best of my knowledge and belief, true, accurate, and complete. I am aware that there are significant penalties for submitting false information.*



---

Signature

Greg Hoagland, P.E.



**21581**

---

Registration Number

March 20, 2024

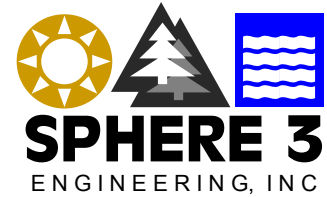

March 20, 2024

Mr. James Robinson  
Alabama Department of Environmental Management  
Groundwater Branch, Land Division  
1400 Coliseum Boulevard  
Montgomery, Alabama 36110-2059

Re: Source Soils Excavation Plan (CP-38)  
Rice Oil Company, Inc., c/o Mr. Rick Parrott  
Harpersville Coosa Mart  
ADEM Facility ID Number: **15217-117-007086**  
Incident Number: **UST12-03-10**  
237 Highway 280 East  
Harpersville, Alabama (Shelby County) 35078  
SPHERE 3 File: RP-ROC.HCM.38

Dear Mr. Robinson:

On behalf of Rice Oil Company, Inc., SPHERE 3 Engineering, Inc. (SPHERE 3) is pleased to submit this Soil Excavation Plan and Alabama Tank Trust Fund (ATTF) Cost Proposal CP-38 for the subject facility. The Cost Proposal was requested by the Alabama Department of Environmental Management (the Department) following review of SPHERE 3's Soil Assessment Report, dated November 7, 2023.

### **Soil Excavation Plan**

The results of the recent soil assessment activities indicate that hydrocarbon-impacted soils, including soils with Chemicals of Concern (COCs) concentrations exceeding applicable Site Specific Target Levels (SSTLs), are present in the vicinity of the former dispensers, and along the southwestern side of the former gasoline UST area. The area of impacted soils is estimated to be approximately 1,350 square feet and, assuming a depth of 10 feet, the volume of impacted soils is estimated to be approximately 13,500 cubic feet, or 500 cubic yards (approximately 750 tons, assuming 1.5 tons per cubic yard). The proposed soil excavation area is shown on Figure 1. While it is possible that additional areas of hydrocarbon-impacted soils are present at the site, the proposed excavation area corresponds to the primary source areas (the former fuel dispensers, product lines, and USTs). Excavation and removal of hydrocarbon-impacted soils in these areas will eliminate source mass, and may expedite the reduction of dissolved-phase COCs concentrations in groundwater at the site.

Prior to conducting the excavation, recovery well RW-1 (which is located within the proposed excavation area) will be abandoned in-place by grouting full depth, from bottom to top. Other monitor wells located near the perimeter of the excavation (including MW-1R, DW-1, and DW-2) also may be affected by the excavation activities. However, SPHERE 3 will attempt to preserve these wells during the excavation process.

### **Loading, Transporting and Backfilling Activities**

Simultaneous with the excavation activities, all waste materials will be loaded and transported to a Subtitle D landfill for permitted disposal under manifest protocol. Transporting the waste

materials will be accomplished with a series of 20-yard rolloff containers or tandem/tri axle dump trucks.

Upon completion of the excavation activities, the excavation site will be backfilled with crushed limestone (CA7, 1-inch or similar) to approximately 24 inches below the land surface. Following the 1-inch crushed limestone, an 18-inch layer of medium to fine grained, clean soils will be applied and compacted. The soils will act as a barrier to seal the area and retard/reduce the infiltration of surface runoff. To complete the backfill, a 6-inch paving layer of crushed limestone (#57, ¾-inch or similar) will be applied to the compacted soils to match the local land surface.

Finally, Type II recovery well RW-1 will be reconstructed. To reconstruct RW-1, a nominal 10-inch diameter soil boring will be advanced at its original location to a depth of approximately 20 feet below the ground surface (bgs). Upon completion, the new soil boring will be completed as Type II recovery monitor well RW-1R using 4-inch diameter PVC materials, including 15 feet of 0.01-inch slotted well screen. Recovery monitor well RW-1R will be completed at the surface with a 12-inch diameter, bolt-down manhole cover secured in a 24-inch square concrete pad poured and finished slightly mounded above the surrounding land surface. A typical Type II monitor cross sectional diagram is provided as Attachment 1. Soil sampling is not proposed, however, the collection of a groundwater sample is proposed from RW-1R to establish a dissolved COCs baseline for benzene, toluene, ethylbenzene, total xylenes (BTEX), methyl-tertiary-butyl-ether (MTBE), and naphthalene.

### **Excavation Plan Implementation Costs**

To provide a cost analysis of the activities associated with this plan, SPHERE 3 solicited quotes from Curtis Service Company, Inc. of Oneonta, Alabama, All Star Construction Company of Orange Beach, Alabama, Big Sky Environmental of Adamsville, Alabama, and Waste Management of Opelika, Alabama. Curtis Service Company provided an all-inclusive proposal, including excavating the source area, loading the waste materials, backfilling/compacting the excavation site, and hauling the waste materials to the selected Subtitle D landfill. All Star Construction Company provided a proposal to include excavating the source area, loading the waste materials, and backfilling/compacting the excavation site. Big Sky Environmental and Waste Management provided proposals to include hauling the waste materials to their respective Subtitle D landfill and permitted disposal.

The proposals are summarized as follows:

#### Excavating, Loading and Backfilling

- Curtis Service Company, Inc. \$74,500.00
- All Star Construction Company \$76,750.00

#### Hauling Waste Materials to Landfill

- Curtis Service Company, Inc. \$56,000.00
- Big Sky Environmental \$93,750.00
- Waste Management \$157,125.00

#### Subtitle D Permitted Disposal

- Big Sky Environmental \$20,250.00
- Waste Management \$42,750.00

Each proposal is provided within Attachment 2. The most economical combination is to allow Curtis Service Company to provide the excavating, loading, hauling and backfilling services and award Big Sky Environmental the disposal services.

### **Management and Reporting**

If approved, SPHERE 3 will prepare and submit a waste profile to the ADEM Land Division to obtain disposal of the waste soils generated during the excavation process. Upon conclusion of the activities proposed herein, SPHERE 3 will prepare and submit a CAP Implementation Report to the Department. This report will include all relevant excavation estimates, disposal documentation, and will provide recommendations for the appropriate future course of action at the facility.

### **Plan Preparation and Implementation Cost Proposal**

ATTF Cost Proposal CP-38 has been prepared to include the cost to prepare this plan and to estimate the costs to implement the activities proposed herein. ATTF Cost Proposal CP-38 will be submitted under separate cover.

It is a pleasure to work with you on this project. If you have any questions or comments, please call. Our telephone number is (205) 403-3317. Thank you.

Sincerely,

**SPHERE 3** ENGINEERING, INC

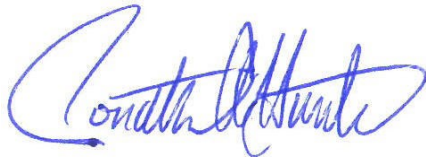

Jonathan A. Hunter, P.G.

cc: Rice Oil Company, Inc., c/o Mr. Rick Parrott



CADD FILE NO. RP-ROCHCM

CHECKED BY

M.E.P.

DRAWN BY

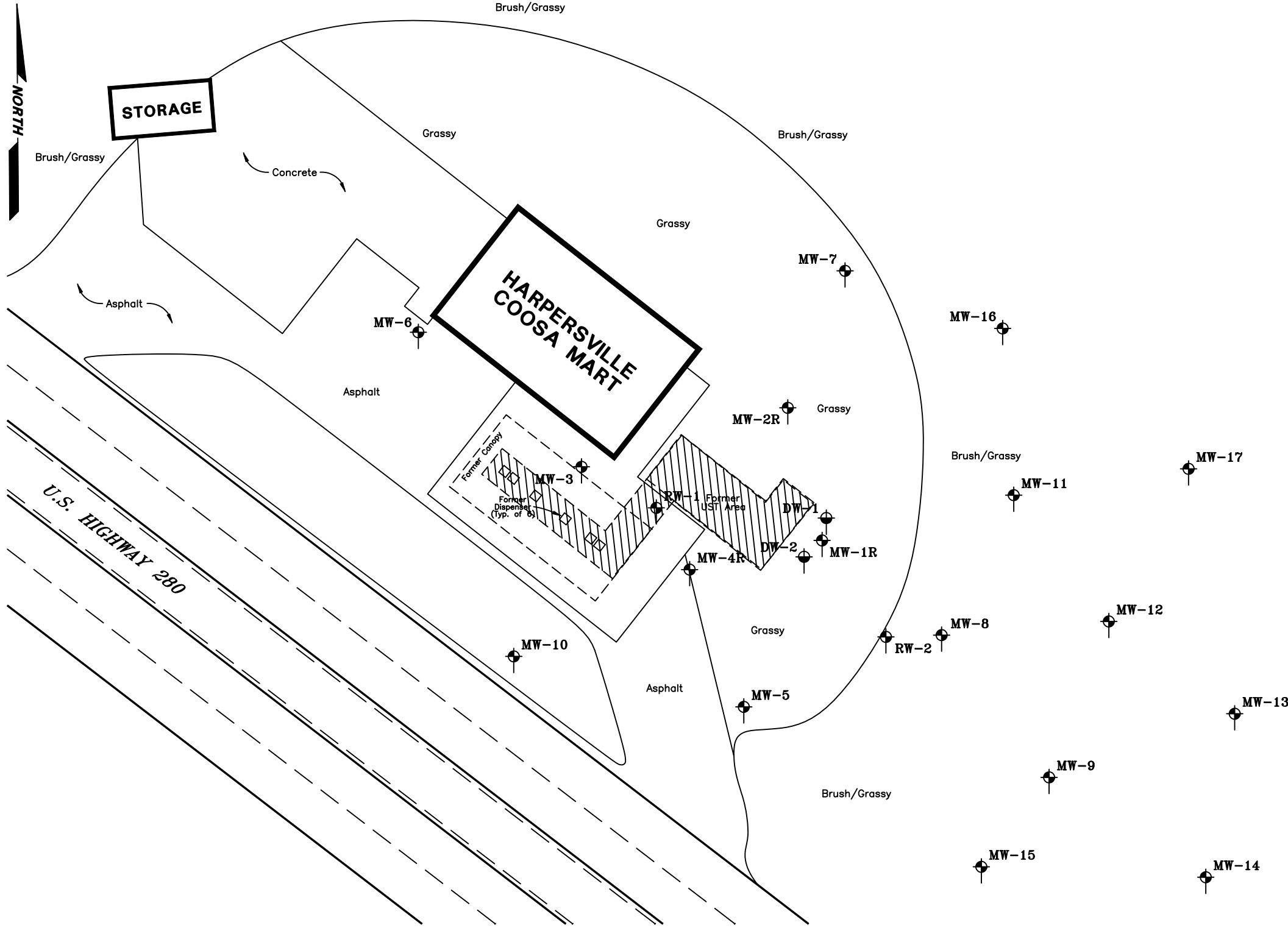

LEGEND	
	Soil Exploration Boring
	Soil Exploration Boring/Type II Monitor Well
	Soil Exploration Boring/Type III Monitor Well
	Proposed Source Soils Excavation Area



DATE	NO.	REVISION	BY

**RICE OIL COMPANY**  
 BIRMINGHAM, ALABAMA 35211  
Client

**SOURCE SOILS EXCAVATION PLAN**  
 HARPERSVILLE COOSA MART (UST12-03-10)  
 237 HIGHWAY 280 EAST  
 HARPERSVILLE, ALABAMA 35078  
Project Title

**PROPOSED AREA FOR SOIL EXCAVATION**

**1**  
Fig. No.

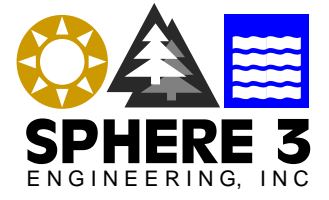



**MW-5**

**CLIENT:** Joe Smith Oil Company  
**LOCATION:** Joe's UST Facility  
 1234 Main Street  
 Anytown, Alabama

**Project No.:** ABC.XYZ.02  
**Top of Riser Pipe Elevation:** 1024.36 feet  
**Ground Surface Elevation:** 1024.89 feet  
**Screened Interval:** 1022.32-1012.58 ft.  
**Date Installed:** 01/04/21

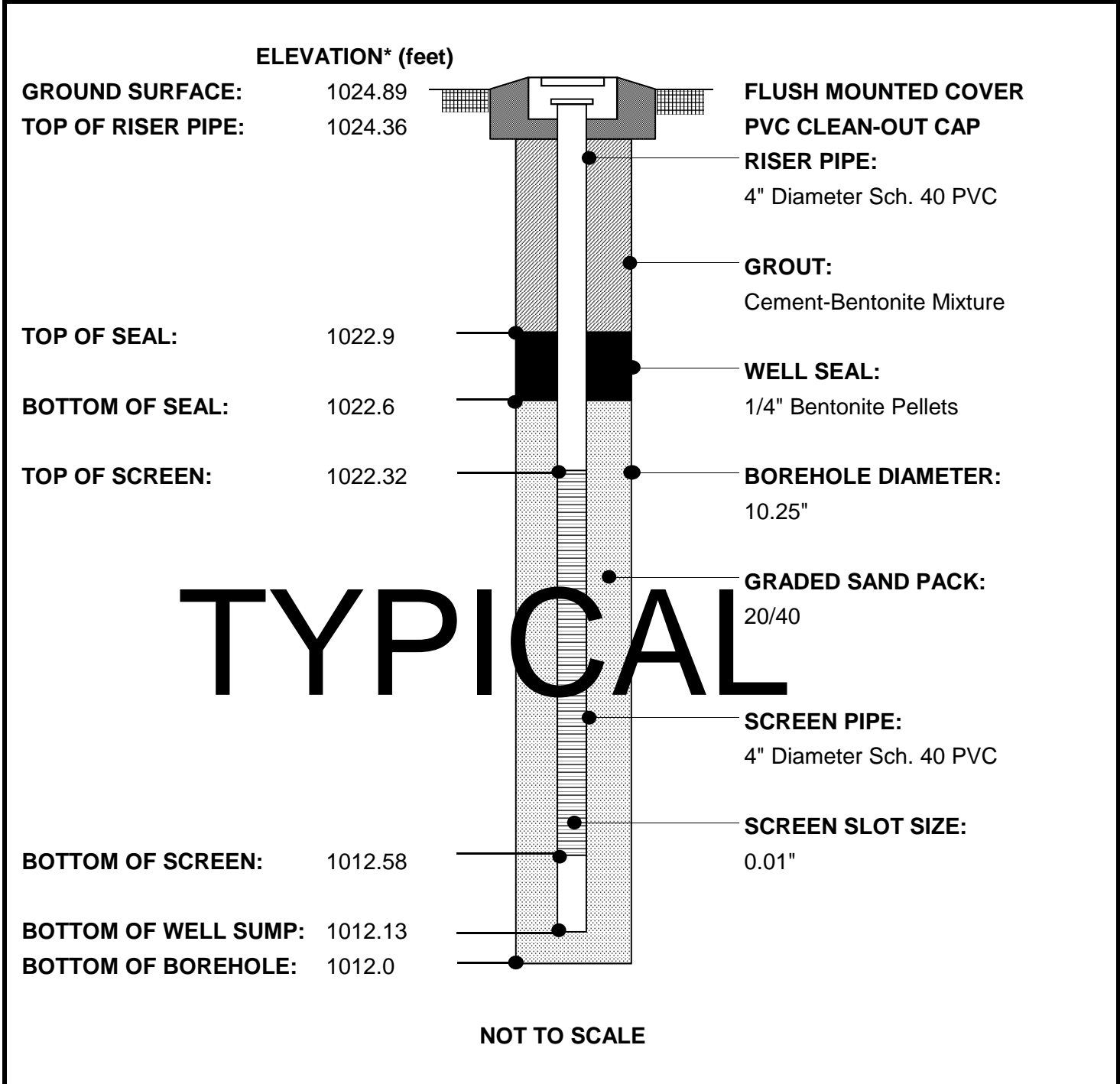

**REMARK:** Monitor well constructed in soil boring B-5

\*-Elevations are referenced to: mean sea level of 1025.00 feet.



CURTIS SERVICE, INC.  
45180 US HWY 231  
ONEONTA, AL 35121 US  
2052128868  
curtis\_service@hotmail.com

# Estimate



ADDRESS
Sphere 3 Engineering, Inc. 3433 Siera Drive Attn: Greg Hogeland greg@sphere3.com Hoover, AL 35216

ESTIMATE #	DATE	
10113	03/04/2024	

P.O. NUMBER:  
Coosa Mart.

JOB LOCATION  
2376 Hwy 280 E. Harpersville

DESCRIPTION	AMOUNT
1- Excavate approx. 1350 sq ft area, 10 ft deep. 2- Haul approx. 750 tons of contaminated dirt. 3- Dirt will be hauled from Harpersville to Adamsville. 4- If water table is bad, we will haul in 57 stone to bridge and stabilize, then put dirt on top. 5- Dirt will be packed and topped with crushed stone. 6- Clean up construction mess. 7- Any more quantities that quoted will be cost plus 20%.	0.00
Machinery	9,500.00
Labor	25,000.00
Hauling in dirt	15,000.00
Hauling of dirt to landfill	56,000.00
Hauling in stone	25,000.00

Any unforeseen issues that arise on the job, will result in a change order.

TOTAL

**\$130,500.00**

PAYMENT TERMS:

- 50% down payment
- 50% at the moment of finish the job.

Accepted By

Accepted Date



Address: 25299 Canal Road  
 Suite A2/1  
 Orange Beach, AL 36561  
 Voice/SMS: (251) 403-2165  
 email: strewnstars@gmail.com

Proposal

Invoice

**CUSTOMER**  
 Greg Hoagland  
 SPHERE 3 Engineering, Inc.  
 3433 Sierra Drive  
 Hoover, AL 35216

**DOCUMENT**  
 EST35-2263

**DATE**  
 3/18/2024

**PROJECT**  
 Coosa Mart

**LOCATION**  
 Harpersville, AL

DESCRIPTION	AMOUNT
beglist	
Excavate an area approximately 1350 sq ft. to a maximum depth of 10 ft.	\$35,000.00
Load approximately 750 tons of excavated material into rolloff containers (supplied by others)	\$18,750.00
If water table is high excavation will be filled with crushed limestone and sealed with clean soil at surface.	\$20,000.00
New soil will be compacted and covered with crushed limestone	\$3,000.00
Clear area of loose debris upon completion	\$0.00
endlist	
notes	

**TOTAL \$76,750.00**

Notes: All overages will be billed at cost plus 20%.

Customer Acceptance \_\_\_\_\_

Date \_\_\_\_\_

## Jon Hunter

---

**From:** Kim Kittle <Kkittle@bigskyenv.com>  
**Sent:** Thursday, December 7, 2023 12:10 PM  
**To:** Jon Hunter  
**Cc:** 'Greg Hoagland'  
**Subject:** Re: Request for quote: "Harpersville Coosa Mart", 237 Highway 280 East, Harpersville, AL

Sorry for the delay response, Pricing is below:

\$150 Delivery x 75 = \$11,250  
\$1100 Final Pull - Liner included x 75 = \$82,500  
Disposal - \$27 per ton x 750 = \$20,250

Total Estimate: \$114,000 + 10% markup  
= \$125,400.00

Assume 500 cubic yards (750 tons). Assume the legal limit of 10 tons per roll off box = 75 boxes.



Kim Kittle  
Email: KKittle@Bigskyenv.com  
Office: 205-743-0080

---

**From:** Jon Hunter <jon@sphere3.com>  
**Sent:** Wednesday, December 6, 2023 9:17 AM  
**To:** Kim Kittle <Kkittle@bigskyenv.com>  
**Cc:** 'Greg Hoagland' <greg@sphere3.com>  
**Subject:** Request for quote: "Harpersville Coosa Mart", 237 Highway 280 East, Harpersville, AL

Hi Kim:

We're planning an excavation/haul/dispose project at this former gas station facility, and I'd like to get a quote for 20 yard roll off boxes (with liners)...deliver/pickup/disposal.

We anticipate generating approximately 500 cubic yards (assume 750 tons) of soil, potentially impacted with petroleum hydrocarbons.

If you have any questions or need additional information, please contact us.

Thanks for your help!

Jon

Jonathan A. Hunter, P.G.  
SPHERE 3 Engineering, Inc.  
27250 Perdido Beach Boulevard  
Suite F2  
Orange Beach, Alabama 36561  
Email: [jon@sphere3.com](mailto:jon@sphere3.com)  
Voice/SMS: (205) 704-0074  
Fax: (205) 403-3318



## Jon Hunter

---

**From:** Lindsey, Steven <slindse1@wm.com>  
**Sent:** Thursday, December 7, 2023 2:02 PM  
**To:** Jon Hunter; Sorenson, Jessica  
**Cc:** 'Greg Hoagland'; Lindsey, Steven  
**Subject:** RE: [EXTERNAL] RE: Request for quote: "Harpersville Coosa Mart", 237 Highway 280 East, Harpersville, AL

Jon,  
Here is the rolloff quote.. plus disposal

Disposal- Star Landfill - Non Haz Soil  
\$57/Ton 4/ton Min Estimated All In may change at the time of service. **x 750 tons = \$42,750**  
Good for 30 Days

Box Spotting: \$965/box Fuel Included **x 75 = \$72,375**

- Includes one hour of unload time
- Delay/Demurrage rate of \$95/hr. to apply after one hour of unload time
- Fuel Surcharge currently 35% - **Included but subject to change**
- Box Rental: \$20/day/box
- **This can be disregarded if this is a live load project.**

Transportation to Star Ridge: \$1,130.00/load Fuel included **x 75 = \$84,750**

- Includes one hour of load and one hour of unload time
- Delay/Demurrage rate of \$95/hr. to apply after one half hour (0.5) of load and one half hour (0.5) of unload
- Fuel Surcharge currently 35% - **Included but subject to change**
- Assumes live load
- A two load per truck minimum to apply per call out.

**Assume 500 cubic yards (750 tons). Assume the legal limit of 10 tons per roll off box = 75 boxes**



**Total Estimate: \$199,875 + 10% markup  
= \$219,862.50**

Steve Lindsey / DGSA  
Special Waste & Hazardous Waste  
Industrial Account Executive Alabama  
[slindse1@wm.com](mailto:slindse1@wm.com)

Salem, Star Ridge, Three Corners and Emelle

Off: 334-745-0181 Salem Landfill  
Cell: 334-740-0813  
4210 Lee Road 183  
Opelika, Al. 36804



Access WM 24/7  
with [My WM](#)



WHAT CAN WM DO? <https://www.wmsolutions.com/resources/brochures/>

Did you know [www.wmsolutions.com](http://www.wmsolutions.com) is your ultimate source for all your industrial services?

- 24-hour access to profiling forms, procedures and regulatory information.
- Run, view, print or download transactional reports at any time, using your existing WM Solutions account.
- WM owned landfills, types of waste they accept, methods of management, hours of operation, maps/directions, brochures and much more!

---

**From:** Jon Hunter <[jon@sphere3.com](mailto:jon@sphere3.com)>

**Sent:** Wednesday, December 6, 2023 9:10 AM

**To:** Lindsey, Steven <[slindse1@wm.com](mailto:slindse1@wm.com)>

**Cc:** 'Greg Hoagland' <[greg@sphere3.com](mailto:greg@sphere3.com)>

**Subject:** [EXTERNAL] RE: Request for quote: "Harpersville Coosa Mart", 237 Highway 280 East, Harpersville, AL

We'll certainly consider roll offs. Give us a quote for that.

Thanks again

Jonathan A. Hunter, P.G.  
SPHERE 3 Engineering, Inc.  
27250 Perdido Beach Boulevard  
Suite F2  
Orange Beach, Alabama 36561  
Email: [jon@sphere3.com](mailto:jon@sphere3.com)  
Voice/SMS: (205) 704-0074  
Fax: (205) 403-3318



---

**From:** Lindsey, Steven [<mailto:slindse1@wm.com>]

**Sent:** Tuesday, December 5, 2023 3:22 PM

**To:** Jon Hunter <[jon@sphere3.com](mailto:jon@sphere3.com)>

**Cc:** Lindsey, Steven <[slindse1@wm.com](mailto:slindse1@wm.com)>

**Subject:** RE: Request for quote: "Harpersville Coosa Mart", 237 Highway 280 East, Harpersville, AL

Jon, every dump truck provider I have called has bowed out are you ok with trying rolloffs?





Steve Lindsey / DGSA  
Special Waste & Hazardous Waste  
Industrial Account Executive Alabama  
[slindse1@wm.com](mailto:slindse1@wm.com)

Salem, Star Ridge, Three Corners and Emelle

Off: 334-745-0181 Salem Landfill  
Cell: 334-740-0813  
4210 Lee Road 183  
Opelika, Al. 36804



Access WM 24/7  
with **My WM**



WHAT CAN WM DO? <https://www.wmsolutions.com/resources/brochures/>

**Did you know** [www.wmsolutions.com](https://www.wmsolutions.com) is your ultimate source for all your industrial services?

- 24-hour access to profiling forms, procedures and regulatory information.
- Run, view, print or download transactional reports at any time, using your existing WM Solutions account.
- WM owned landfills, types of waste they accept, methods of management, hours of operation, maps/directions, brochures and much more!

---

**From:** Jon Hunter <[jon@sphere3.com](mailto:jon@sphere3.com)>

**Sent:** Monday, December 4, 2023 11:00 AM

**To:** Lindsey, Steven <[slindse1@wm.com](mailto:slindse1@wm.com)>

**Cc:** 'Greg Hoagland' <[greg@sphere3.com](mailto:greg@sphere3.com)>

**Subject:** RE: [EXTERNAL] Request for quote: "Harpersville Coosa Mart", 237 Highway 280 East, Harpersville, AL

Hard to answer that with any degree of certainty. We'll have to get the proposal and cost estimate to ADEM, then they'll have to approve it....and we'll then have the green light to get going.

However, let's assume that we'll be ready to go by mid February. I'm gonna guess 8 loads per day. So, we may be able to finish in 5 days.

(Greg Hoagland: if you have other thoughts about this, please chime in)

Jonathan A. Hunter, P.G.  
SPHERE 3 Engineering, Inc.  
27250 Perdido Beach Boulevard  
Suite F2  
Orange Beach, Alabama 36561  
Email: [jon@sphere3.com](mailto:jon@sphere3.com)  
Voice/SMS: (205) 704-0074  
Fax: (205) 403-3318



---

**From:** Lindsey, Steven [<mailto:slindse1@wm.com>]  
**Sent:** Monday, December 4, 2023 10:52 AM  
**To:** Jon Hunter <[jon@sphere3.com](mailto:jon@sphere3.com)>  
**Cc:** 'Greg Hoagland' <[greg@sphere3.com](mailto:greg@sphere3.com)>  
**Subject:** RE: [EXTERNAL] Request for quote: "Harpersville Coosa Mart", 237 Highway 280 East, Harpersville, AL

Do you have a date of when you would want this run? And what time frame for it to be run? How many loads per day?

Steve Lindsey / DGSA  
Special Waste & Hazardous Waste  
Industrial Account Executive Alabama  
[slindse1@wm.com](mailto:slindse1@wm.com)

Salem, Star Ridge, Three Corners and Emelle

Off: 334-745-0181 Salem Landfill  
Cell: 334-740-0813  
4210 Lee Road 183  
Opelika, Al. 36804



Access WM 24/7  
with [My WM](#)



WHAT CAN WM DO? <https://www.wmsolutions.com/resources/brochures/>

**Did you know** [www.wmsolutions.com](https://www.wmsolutions.com) is your ultimate source for all your industrial services?

- 24-hour access to profiling forms, procedures and regulatory information.
- Run, view, print or download transactional reports at any time, using your existing WM Solutions account.
- WM owned landfills, types of waste they accept, methods of management, hours of operation, maps/directions, brochures and much more!

---

**From:** Jon Hunter <[jon@sphere3.com](mailto:jon@sphere3.com)>  
**Sent:** Monday, December 4, 2023 10:40 AM  
**To:** Lindsey, Steven <[slindse1@wm.com](mailto:slindse1@wm.com)>  
**Cc:** 'Greg Hoagland' <[greg@sphere3.com](mailto:greg@sphere3.com)>  
**Subject:** [EXTERNAL] Request for quote: "Harpersville Coosa Mart", 237 Highway 280 East, Harpersville, AL

Hi Steve:

As we discussed on the phone this morning, we're planning an excavation/haul/dispose project at this former gas station facility.

We anticipate generating approximately 500 cubic yards (around 750 tons) of soil, potentially impacted with petroleum hydrocarbons.

We'd like to get a quote for the hauling (via dump trucks) and disposal of the soil. Once we receive the quote, we will be preparing a proposal and cost estimate to forward to ADEM, along with your quote. It'd be a big help if the quote is relatively clear and simple to decipher, so that we can put the correct numbers in our cost estimate.

If you have any questions or need additional information, please contact us.

Thanks for your help!

Jon

Jonathan A. Hunter, P.G.  
SPHERE 3 Engineering, Inc.  
27250 Perdido Beach Boulevard  
Suite F2  
Orange Beach, Alabama 36561  
Email: [jon@sphere3.com](mailto:jon@sphere3.com)  
Voice/SMS: (205) 704-0074  
Fax: (205) 403-3318



---

**Recycling is a good thing. Please recycle any printed emails.**

**TECHNICAL DRILLING SERVICES, INC.**  
**QUOTE FORM**  
For  
**SPHERE 3 ENGINEERING, INC.**  
**HARPERSVILLE COOSA MART**  
**HARPERSVILLE, ALABAMA**

**Date: March 8, 2024**

<b>Description</b>	<b>Units</b>	<b>Estimated Quantity</b>	<b>Unit Cost</b>	<b>Total Cost</b>
Mobilization/demobilization	LS	1	300.00	300.00
Mobilization/demobilization	Mile	220	3.93	864.60
Mobilization/demobilization	Mile	0	1.97	0.00
Per diem (3 man crew)	Day	1	255.00	255.00
GeoProbe or ATV rig if site conditions warrant	Day	0	250.00	0.00
Drill, sample & abandon a soil boring*	Foot	0	30.00	0.00
Shelby Tube sample	Each	0	58.00	0.00
MW/RW Tremie Grout Abandonment	Foot	20	18.00	360.00
Additional splitspoon sample for frequency > 5' intervals	Each	0	20.00	0.00
Drill, sample & install a 2" PVC Type II well in soil*	Foot	0	65.00	0.00
Drill, sample & install a 4" PVC Type II well in soil*	Foot	20	70.00	1400.00
Construct a concrete pad & install an 8" flush cover	Each	0	205.00	0.00
Construct a concrete pad & install an 12" flush cover	Each	1	242.00	242.00
55-Gallon drum	Each	0	75.00	0.00
Standby rate	Hour	0	250.00	0.00

**TOTAL JOB ESTIMATE: \$3,421.60**

**TOTAL MINIMUM JOB: \$4,164.60**

\*Price includes splitspoon samples taken at 5-foot intervals.



# Cost Proposal

PO Box 1147  
Foxworth, MS 39483

Date	Proposal #
11/30/2023	17863

Name / Address
Sphere 3 Engineering, Inc. 3433 Sierra Drive Hoover, AL 35216

Re:
Environmental Services Harpersville Coosa Mart 237 Hwy 280 East Harpersville, AL

Description	Unit	Qty	Rate	Total
Mobilize/Demobilize	lump sum	1	2,540.00	2,540.00T
Drill, Sample & Install (1) 4" PVC Monitor Wells	per foot	20	70.00	1,400.00T
12" Flush Mount Covers	per each	1	242.00	242.00T
Per-Diem	per man day	6	100.00	600.00T

Customer Acceptance of Cost Proposal

Authorized Signature \_\_\_\_\_ Date \_\_\_\_\_

\*Payment Terms NTE 30 days upon project completion.  
\*1.5% Interest will be charged monthly to all overdue invoices.

<b>Subtotal</b>	\$4,782.00
<b>Tax (0.0%)</b>	\$0.00
<b>Total</b>	\$4,782.00

Walker-Hill Environmental, Inc  
Foxworth, MS Office  
Phone: (601) 736-3500  
Email: eric@whenv.com